

### Features

- Diverter spout
- 144 mm (5.69 inch) spout reach
- 4.48 gpm (17.0 lpm) maximum flow rate at 43.5 psi (3.0 bar)
- 31.8 mm (1.25 inch) max hole diameter

### Material

- Premium material construction for durability and reliability
- KOHLER finishes resist corrosion and tarnishing

### Installation

- Wall-mount



### Codes/Standards



None Applicable

### KOHLER® India Faucet, Sanitaryware and Bathing Products Limited Warranty

See website for detailed warranty information.

### Available Colors/Finishes

*Color tiles intended for reference only.*

Color	Code	Description
	CP	Polished Chrome
	AF	Vibrant® French Gold

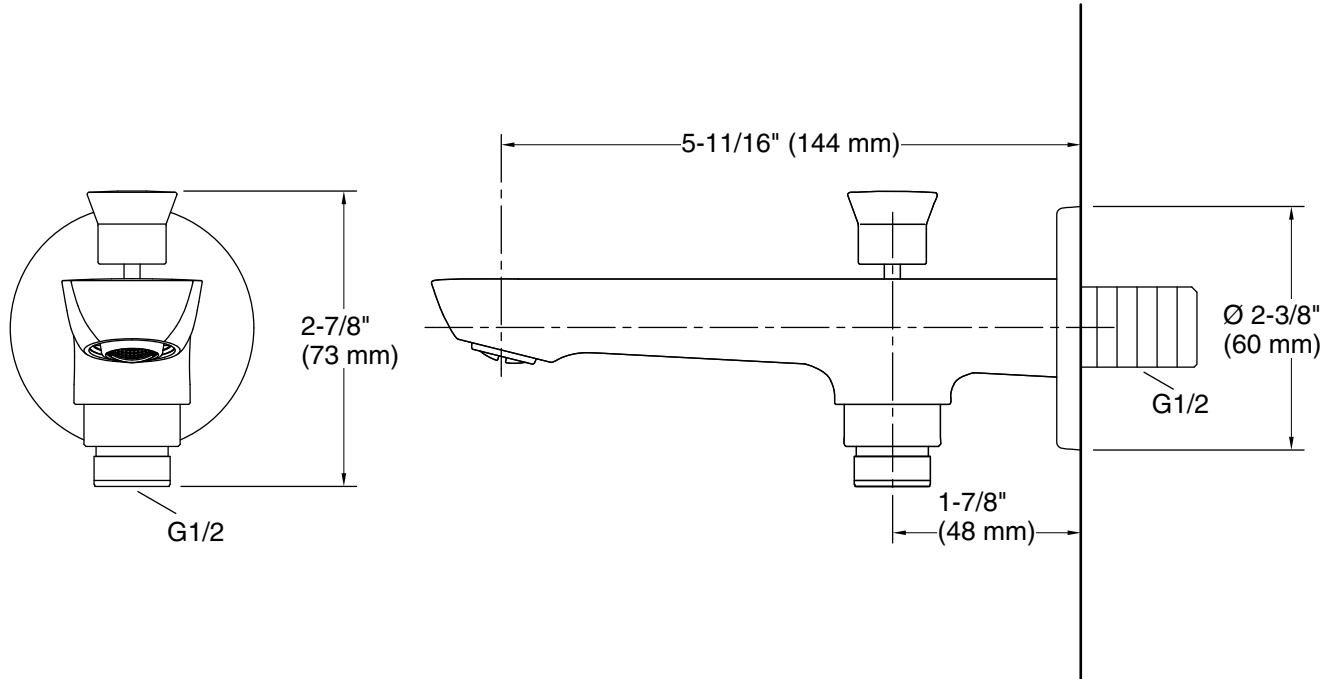

## Technical Information

All product dimensions are nominal.

## Notes

Install this product according to the installation instructions.