

Features

- Thermostatic valve allows user to set and maintain precise temperature
- Antiscald protection
- Adjustable high-temperature limit for added safety
- Thermostatic technology automatically maintains outlet temperature during water pressure fluctuations and/or inlet water temperature changes
- Requires recessed bath/shower trim (sold separately)

Material

- Brass valve body
- KOHLER finishes resist corrosion and tarnishing

Installation

- Recessed

Required Products/Accessories

K-20741IN-9FP Recessed thermostatic bath and shower valve trim with Knob handles

or

K-24431IN-9FP Recessed thermostatic bath and shower valve trim with Knob handles

or

K-20742IN-9FP Recessed thermostatic bath & shower valve trim with square handles



Codes/Standards

None Applicable

KOHLER® India Faucet, Sanitaryware and Bathing Products Limited Warranty

See website for detailed warranty information.

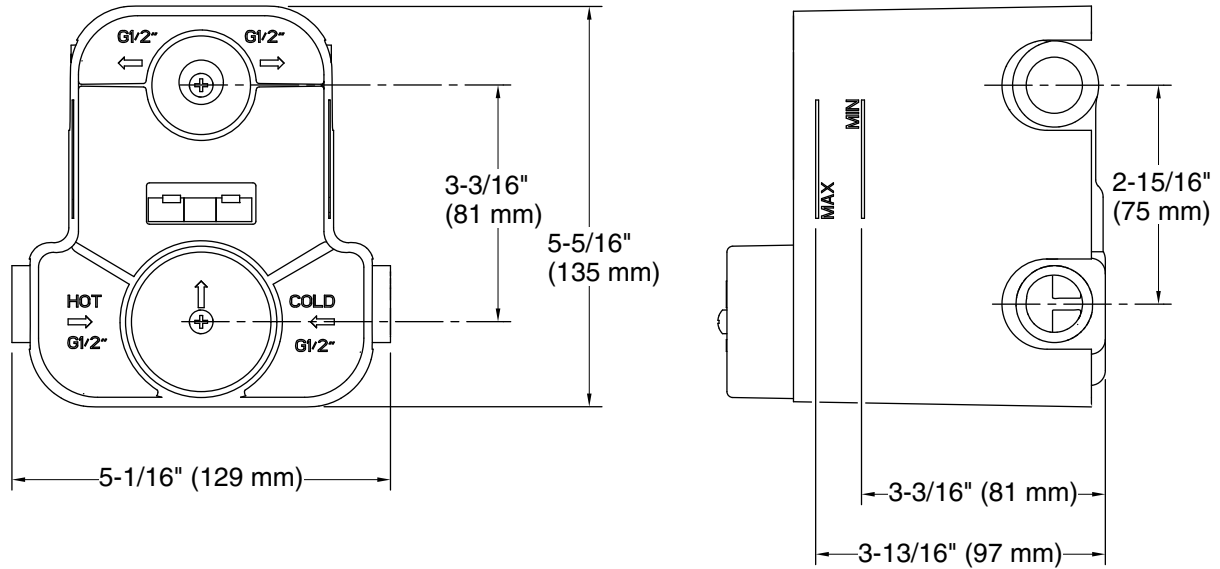

Technical Information

All product dimensions are nominal.

Notes

Install this product according to the installation instructions.